

Industrial Gas Meter G25

Exact measurement and security



Overview

The gas meter G25 is designed for measurement of gas supplied to industrial plants where maximum consumption of gas is equivalent to 40m³/h of air of density of 1,2 kg/m³ and the ambient temperature remains between -25°C and +55°C.

Gas meter can be equipped with pulse generator (1 imp = 0,1m³) and then the gas meter is marked G25N

The gas meters can be used for measurement of:

- Natural gas
- City gas
- Propane-butane gas

Typical error curves

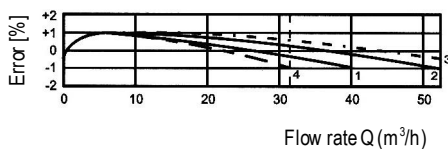

Flow rate Q (m³/h)

Dimensions

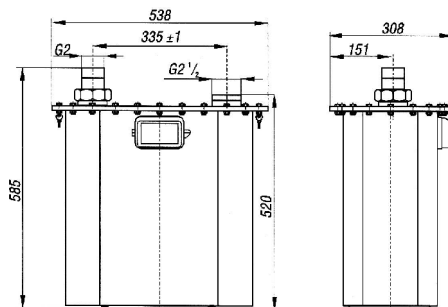

Technical Data

Maximum flow rate:	40 m ³ /h
Minimum flow rate:	0,25 m ³ /h
Nominal flow rate:	25 m ³ /h
Cyclic volume:	20 dm ³
Maximum working pressure:	0,2 bar
Index max indication volume:	99999,999m ³
Starting flow rate:	20 dm ³ /h
Weight:	30 kg

Pressure loss curves

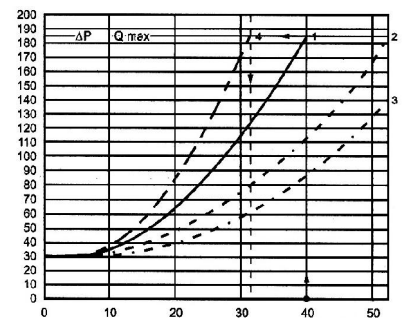

- 1 – air
- 2 – natural gas
- 3 – city gas
- 4 – propane-butane

